



South Edmonton Strip Mall Site

5.19 Acres SE Edmonton



Alberta, Edmonton



South Edmonton Strip Mall Site

5.19 Acres SE Edmonton

Price: \$2,875,260

Acres: 5.19

- Features:*
- *Future Commercial Strip Mall Site !!*
 - *Next to major City of Edmonton future ETS Transit Centre !*
 - *Southeast Edmonton continues to see Phenomenal Growth relative to the Edmonton Region !!*
 - *Southeast Edmonton is a Highly Sought-after destination for Builders, Developers, and home Buyers !!*
 - *Many Planned Parklands & Trails Nearby !!*
 - *South Edmonton Lot Prices High in this area !!*
 - *49,300 Vehicles per day at the Ellerslie / 50 Street intersection !*

KELLEY URBAN LAND



Dylan@KelleyUrbanLand.com
Tel: (780) 488-4000

KELLEY URBAN LAND



Dylan@KelleyUrbanLand.com
Tel: (780) 488-4000

KELLEY URBAN LAND

Anthony Henday Dr.



Ellerslie Rd SW

50 St. SW



- | | |
|---|---------------------------------------|
| ••••• NSP Boundary | ■ School / Park (MR) |
| ETS Future Transit Centre / Park & Ride | ★ Pocket Park (MR) |
| ■ Low Density Residential | ■ Natural Area (MR) |
| ■ Street-Oriented Residential | ■ Natural Area (ER) |
| ■ Medium Density Residential | ■ Natural Area (ER) to be determined* |
| ■ Potential Development Area (MDR) | ■ Pipeline R/W |
| ■ Town Centre Mixed Use | ■ City Owned Lands |
| ■ Mixed Use | ■ Non ER on City Owned Parcels |
| ■ Community Commercial | → Arterial Roadway |
| ■ Neighbourhood Commercial | → Collector Roadway |
| ■ Stormwater Management Facility | ■ Special Study Area |
| ■ Institutional / Residential Mixed Use | ■ Civic Use |
| ■ Parkland (non-MR) | |

Dylan@KelleyUrbanLand.com
Tel: (780) 488-4000



Anthony Henday Dr.

Site | Site

HWY 2

KELLEY URBAN LAND

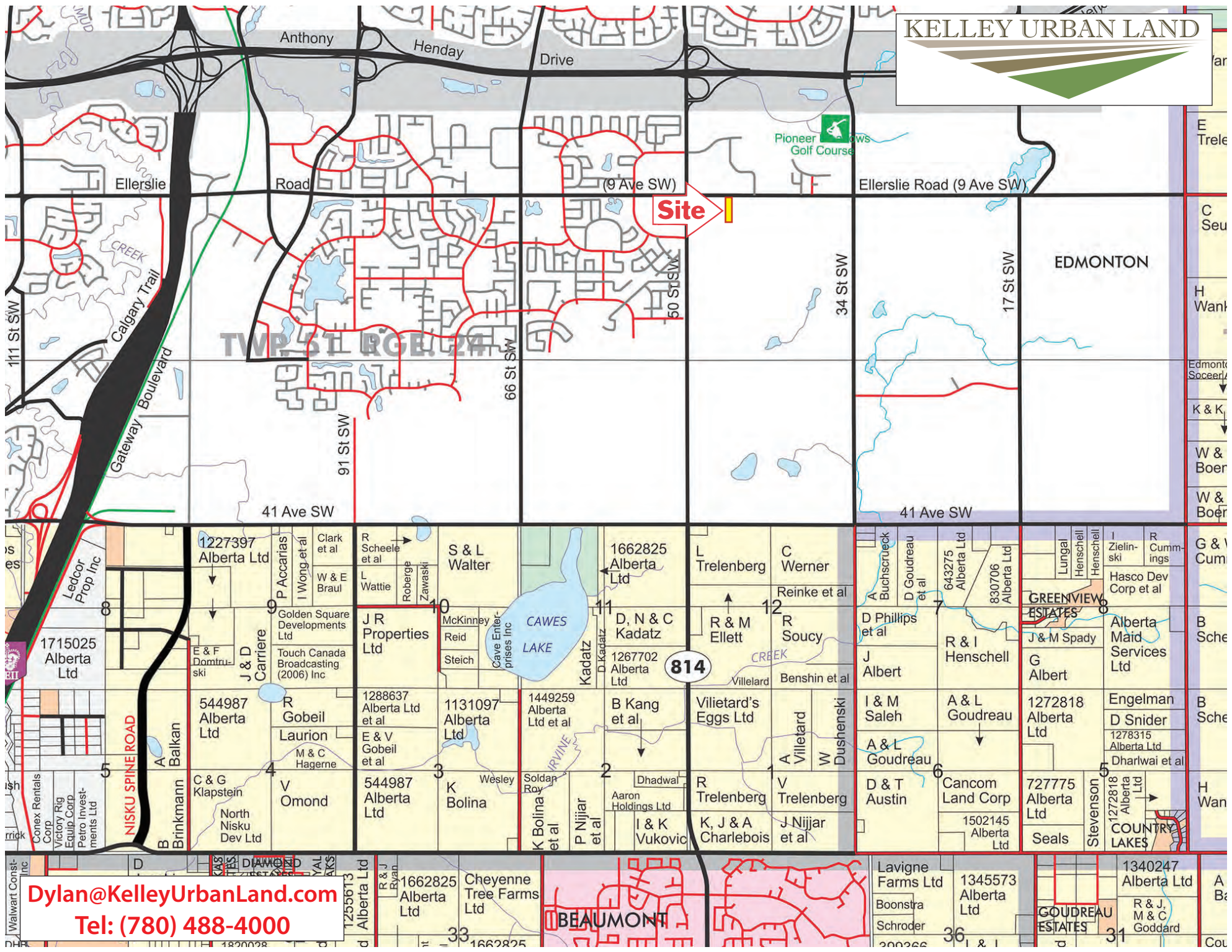

Site

EDMONTON

814

Dylan@KelleyUrbanLand.com
Tel: (780) 488-4000

BEAUMONT

GOUDREAU ESTATES

COUNTRY LAKES

GREENVIEW ESTATES

NISKU SPINE ROAD

TWP 51 RGE 24